

LEGEND

- UTAH COUNTY MONUMENT
- UTAH COUNTY/SALT LAKE COUNTY 3.5" BRASS CAP
- UTAH COUNTY/SALT LAKE COUNTY 3.5" ALUMINUM CAP
- BOUNDARY LINE
- SECTION LINES

FINAL LOCAL ENTITY PLAT UTAH COUNTY/SALT LAKE COUNTY BORDER

A PORTION OF THE UTAH COUNTY/SALT LAKE COUNTY BORDER LOCATED IN THE NORTHWEST QUARTER OF SECTION 11, THE SOUTH HALF OF SECTION 2 AND THE SOUTHWEST QUARTER OF SECTION 1, TOWNSHIP 4 SOUTH, RANGE 1 EAST, SALT LAKE BASE & MERIDIAN.

POINT 9

N70°37'59"E
GRID: 1785.37'
GROUND: 1786.00'
COMBINED SCALE FACTOR: 0.999649207

POINT 8

N38°27'10"E
GRID: 522.10'
GROUND: 522.28'
COMBINED SCALE FACTOR: 0.999657622

POINT 7

N86°06'53"E
GRID: 437.73'
GROUND: 437.87'
COMBINED SCALE FACTOR: 0.999661112

POINT 6

N39°43'04"E
GRID: 1041.82'
GROUND: 1042.17'
COMBINED SCALE FACTOR: 0.999664603

POINT 5

S88°55'28"E
GRID: 304.73'
GROUND: 304.83'
COMBINED SCALE FACTOR: 0.99966729

POINT 3

N29°20'48"E
GRID: 413.60'
GROUND: 413.74'
COMBINED SCALE FACTOR: 0.99967438

POINT 2

N68°39'43"E
GRID: 1110.24'
GROUND: 1110.61'
COMBINED SCALE FACTOR: 0.999665449

POINT 1

N00°06'20"E (TIE)
GRID: 718.48'
GROUND: 718.72'
COMBINED SCALE FACTOR: 0.999665

EAST (TIE)
GRID: 181.82'
GROUND: 181.88'
COMBINED SCALE FACTOR: 0.999665

N68°39'43"E
GRID: 1110.24'
GROUND: 1110.61'
COMBINED SCALE FACTOR: 0.999665449

COORDINATE SYSTEM

NAME: UNITED STATES/NAD83
ZONE: UTAH CENTRAL 4302
DATUM: NAD83(2011)
GLOBAL REFERENCE DATUM: NAD83(2011)
GLOBAL REFERENCE EPOCH: 2010
GEOID: GEOID18 (CONUS)

Point #	Northing	Easting	Elevation	Latitude (Global)	Longitude (Global)	Combined Scale Factor
1	7346748.58	1553827.65	6254.97	40°29'17.86739"	-111°48'40.70566"	0.999667431
2	7347152.56	1554861.78	6342.52	40°29'21.89483"	-111°48'27.33921"	0.999663466
3	7347678.75	1555390.37	6265.78	40°29'27.11244"	-111°48'20.52095"	0.999667419
4	7348039.27	1555593.07	6269.09	40°29'30.68179"	-111°48'17.91324"	0.999667457
5	7348033.55	1555897.75	6276.01	40°29'30.63552"	-111°48'13.96945"	0.999667123
6	7348834.92	1556563.48	6390.66	40°29'38.57681"	-111°48'05.38756"	0.999662082
7	7348864.58	1557000.2	6431.58	40°29'38.88443"	-111°47'59.73608"	0.999660142
8	7349273.45	1557324.88	6541.78	40°29'42.93544"	-111°47'55.55112"	0.999655101
9	7349865.51	1559009.22	6795.26	40°29'48.84113"	-111°47'33.77407"	0.999643312

LEGAL DESCRIPTION

A PORTION OF THE UTAH COUNTY/SALT LAKE COUNTY BOUNDARY LOCATED IN THE NORTHWEST QUARTER OF SECTION 11, SOUTH HALF OF SECTION 2 AND THE SOUTHWEST QUARTER OF SECTION 1, TOWNSHIP 4 SOUTH, RANGE 1 EAST, SALT LAKE BASE & MERIDIAN;
BEGINNING AT A 3.5" BRASS CAP MARKING THE EXISTING UTAH COUNTY/SALT LAKE COUNTY BOUNDARY AT THE INTERSECTION OF THE CROSS RANGE SUMMIT AND THE BOUNDARY LINE AS ESTABLISHED BY AMENDED JOINT RESOLUTION 2005-68, ENTRY NO. 148046:2005, UTAH COUNTY RECORDS AND 3799, ENTRY NO. 9590990, SALT LAKE COUNTY RECORDS; SAID POINT OF BEGINNING LOCATED N 00°06'20" E 718.72 FEET FOLLOWING AN EXTENSION OF THE SECTION LINE BETWEEN THE SOUTHWEST AND THE WEST QUARTER CORNERS OF SAID SECTION 11 AND EAST 181.88 FEET FROM THE WEST QUARTER OF SECTION 11, TOWNSHIP 4 SOUTH, RANGE 1 EAST, SALT LAKE BASE & MERIDIAN;
THENCE ALONG SAID CROSS RANGE SUMMIT AND UTAH COUNTY/SALT LAKE COUNTY BOUNDARY THE FOLLOWING (8) COURSES: N 68°39'43" E 1110.61 FEET TO A UTAH COUNTY/SALT LAKE COUNTY 3.5" BRASS CAP; N 45°07'49" E 746.09 FEET TO A UTAH COUNTY/SALT LAKE COUNTY 3.5" BRASS CAP; N 29°20'48" E 413.74 FEET TO A UTAH COUNTY/SALT LAKE COUNTY 3.5" BRASS CAP; S 88°55'28" E 304.83 FEET TO A UTAH COUNTY/SALT LAKE COUNTY 3.5" BRASS CAP; N 39°43'04" E 1042.17 FEET TO A UTAH COUNTY/SALT LAKE COUNTY 3.5" BRASS CAP; N 86°06'53" E 437.87 FEET TO A UTAH COUNTY/SALT LAKE COUNTY 3.5" BRASS CAP; N 38°27'10" E 522.28 FEET TO A UTAH COUNTY/SALT LAKE COUNTY 3.5" BRASS CAP; N 70°37'59" E 1786.00 FEET TO A UTAH COUNTY/SALT LAKE COUNTY 3.5" ALUMINUM CAP.

BASIS OF BEARING

THE BASIS OF BEARING FOR THIS SURVEY IS N 00°06'20" E ALONG THE SECTION LINE, AS SHOWN HEREON.

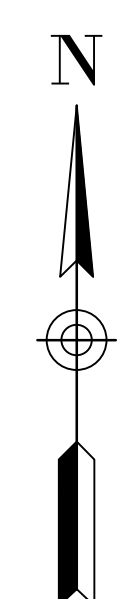

CAP DETAILS

BRASS ALUMINUM



SURVEYOR CERTIFICATE

We hereby certify and verify that the boundary line between Salt Lake and Utah Counties as shown on this plat was established jointly by the County Surveyor's of said Salt Lake and Utah Counties as authorized by Utah State Code 17-50-105 Disputed Boundaries. We further certify and verify that this Final Local Entity Plat is in accordance with Utah State Code 17-23-20 and is true and correct

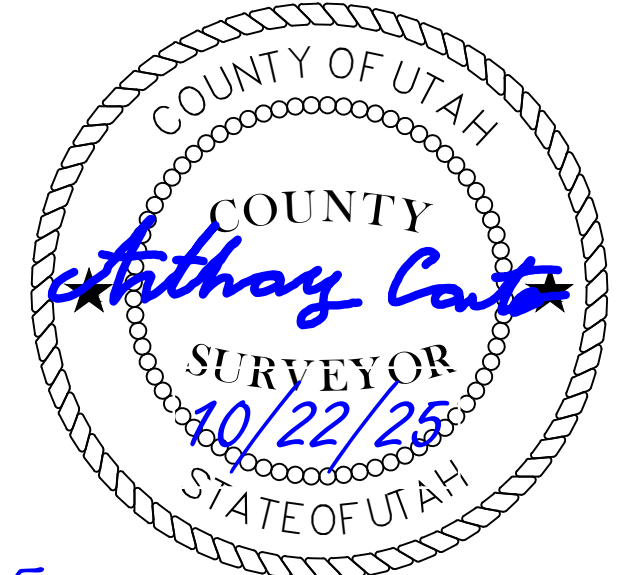

Anthony Carter 10/22/25
UTAH COUNTY SURVEYOR

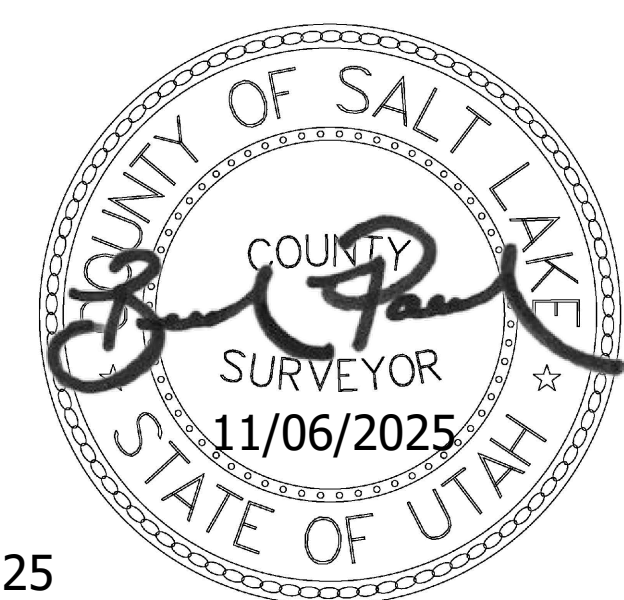

Paul Paul 11/06/2025
SALT LAKE COUNTY SURVEYOR

COUNTY RECORDER INFORMATION

UTAH COUNTY SURVEY OFFICE
2855 SOUTH STATE STREET
PROVO, UT 84606
(801) 851-8600
SURVEYOR@UTAHCOUNTY.GOV



FINAL LOCAL ENTITY PLAT
UTAH COUNTY & SALT LAKE COUNTY BOUNDARY LINE

SCALE: 1" = 250'
DATE: 8/11/2025

SALT LAKE COUNTY SURVEY OFFICE
2001 SOUTH STATE STREET
STE # N1-400
SALT LAKE CITY, UT 84114
(385) 468-8240



NOTICE OF TRUE LOCATION OF COUNTY BOUNDARY

TO: The Lieutenant Governor, State of Utah

NOTICE IS HEREBY GIVEN that pursuant to UCA 17-50-105 (2), the county surveyors of Utah and Salt Lake counties have determined the true location of a section of the boundary between the two counties which was disputed or uncertain. The county surveyors have identified and marked the true location of the county boundary with physical monuments and have provided legal descriptions for the recording of the true boundary.

Accompanying this notice is a copy of the final local entity plat titled **UTAH COUNTY & SALT LAKE COUNTY BOUNDARY LINE** which has been approved by the surveyors for Utah County and Salt Lake County. Utah County and Salt Lake County hereby request that the official records maintained by the State of Utah in the office of the Lieutenant Governor be changed to reflect the true location of this county boundary.

Dated this 11 day of December, 2025,

UTAH COUNTY SURVEYOR



Anthony Canto

SALT LAKE COUNTY SURVEYOR



Bradley E. Park